

Mathematics STAAR® Workstations Volume 4 Features

Fraction, Decimal, Percent
TEKS 6(4)(G)
Reporting Category 1
Numerical Representations and Relationships

Materials
For the folder

- Workstation document
- Red folder
- Red cardstock for answer key cover
- Additional red cardstock
- Hook-and-loop dot
- Packing tape
- Plastic sandwich bag
- Number cube

1. Print the workstation document.
2. Cut out, arrange, and glue the *Cover* to the front of the folder.
3. Cut out and glue the *Folder Tab Label* to the tab of the folder.

Materials listed aid in activity preparation.

Each activity addresses a specific student expectation that is reflected in the content objective(s).

A different color folder is used for each reporting category to aid in organization. Manila folders may also be used.

The titles of **Activity Masters** and **Student Pages** are printed in italics for ease of reference.

Reporting Category Folder Color Recommendations

- Reporting Category 1: Red Folders
- Reporting Category 2: Yellow Folders
- Reporting Category 3: Green Folders
- Reporting Category 4: Blue Folders

Mathematics STAAR® Workstations Volume 4 Features

Front Cover

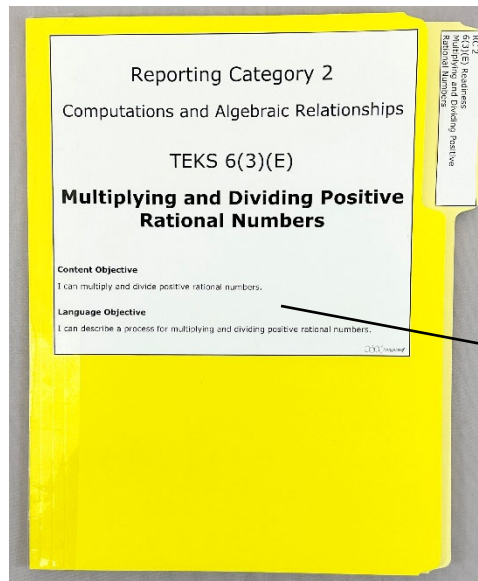

Folder Tab Labels are provided to aid in organization of folders.

Content Objective and **Language Objective** describe the focus of the TEKS-based activity in student-friendly language.

Back Cover

Cardstock Cover keeps an answer key secure until students are ready to check their work.

The **Answer Key** allows students to self-check their answers to each task.

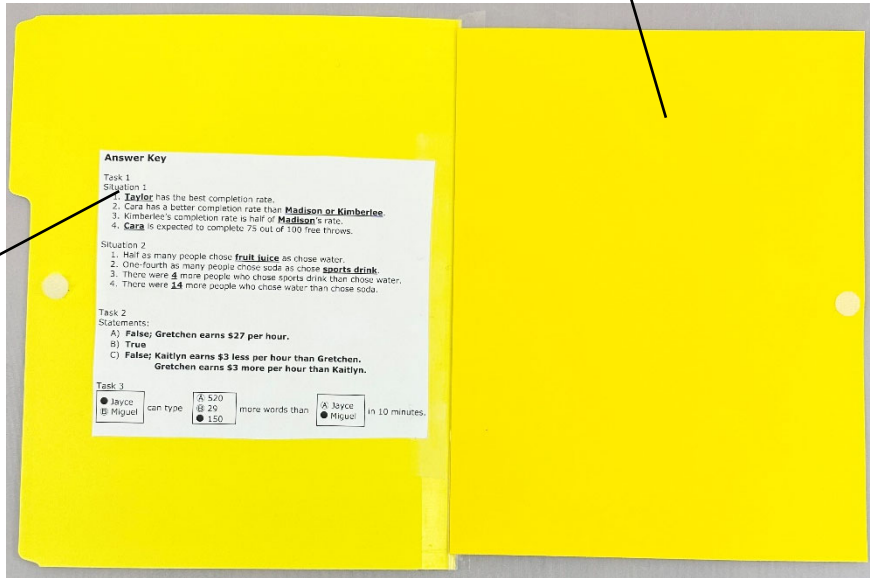

Mathematics STAAR® Workstations Volume 4 Features

Inside Folder

Each workstation includes step-by-step instructions to aid students in completing each task.

Some workstations include card sorts or have other manipulatives. Cards are stored in the folder either in a pocket (created using cardstock or an envelope) or in a resealable plastic bag.

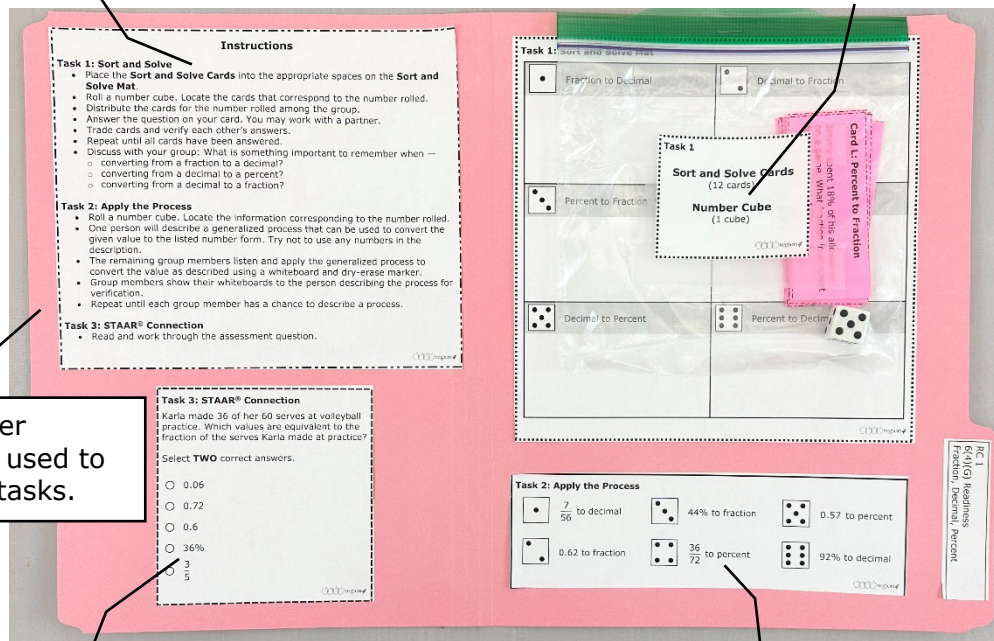

Varied border designs are used to distinguish tasks.

A STAAR® formatted assessment item is included in each station.

Each workstation includes a literacy component to promote understanding and academic vocabulary.

Name: _____ Date: _____

Mean, Median, Range, Interquartile Range Recording Sheet

Task 2: What Is My Value?

Data Set A

Data Set B

Task 3: STAAR® Connection
Write the correct answer in each box. Not all answers will be used.

18 22 27 29 30

The mean of the data is .

The median of the data is .

The range of the data is .

I determined the answers by ...

©2023 Region 4 Education Service Center

Each workstation includes a reproducible master that provides students with a study guide.